

Section –A: Ported Carriers

PORTED CARRIER

GUN SIZES: 3-1/8", 3-3/8", 4" & 5"

RETRIEVABLE STEEL PORTED GUNS

Retrievable steel hollow carrier “port plug guns” are appropriate for wireline casing and liner perforating carried out before production tubing is run where the labour cost of redressing the carriers is economically viable.

FEATURES

- 1) Ported tabular steel carriers are retrievable and reusable.
- 2) Explosive components are completely enclosed and isolated from well fluids providing higher reliability than tubing expendable type guns
- 3) Deep penetrating charges and Big-hole charges with favorable shot distribution provide adequate gun performance.
- 4) Charge debris is removed from the well with the carrier.
- 5) No casing damage - lateral explosive forces are completely absorbed by the air cushion around the charges and heavy carrier walls.
- 6) Monocable selectivity - ballistically actuated switches or two-gun “diode plugs” firing carrier by carrier, from bottom up.

SPECIFICATIONS

- | | | |
|---|---|---|
| 1) Shot Density | : | 1 to 8 shots per foot |
| 2) Phasing | : | 90 Deg. or 120 Deg. |
| 3) Maximum Gun Length | : | Limited by cable strength and riser length. |
| 4) Explosive Package Temperature Rating | : | RDX - 330 Deg. F for 1 Hr
HMX - 380 Deg. F for 1 Hr |
| 5) System Pressure Rating - dependent on port plug accepted | : | Carrier (usually 15,000 to 20,000 psi)
Port plug Type –
2,000psi, 15,000psi, 20,000psi. |

PORTED CARRIER ASSEMBLY (WIRELINE)	
ITEMS	DESCRIPTION
1	CARRIER, xSPF, 90° or 120° PHASE Carrier Diameter: 3-1/8", 3-3/8", 4", 5" Carrier Length from 3 to 12 FT Shot Density from 1 to 8 SPF
2	RUBBER JACKET
3	ALIGNMENT WASHER
4	ALIGNMENT SLEEVE
5	PORT PLUG (STEEL, UNGROOVED)
6	PORT PLUG WASHER
7	BOTTOM NOSE, W.L
8	INTERCARRIER, SELECTIVE, W.L
9	PLUG, BOTTOM NOSE
10	PLUG, INTERCARRIER SELECTIVE, WITH O-RING
11	ADAPTOR HEAD, UPPER, W.L
12	DETCORD
13	DETONATOR, FLUID DESENSITIZED
14	CHARGE (Various)
15	O-RING FOR CARRIER
16	O-RING FOR PLUG, BOTTOM NOSE
17	CONTACT ROD ASSEMBLY
18	DUAL DIODE PLUG
19	SELECTIVE SWITCH, LC TYPE I (RED)
20	SELECTIVE SWITCH, LC TYPE II (GREEN)
21	RUBBER SHIELD
22	CONNECTOR, INSULATED MALE
23	SHOCK DISK
24	TERMINAL RING, INSULATED
25	SCREW RD HD, 1/4"-20x3/8" BRASS
26	RETAINER NUT
27	ADAPTOR HEAD REDRESS KIT, W.L

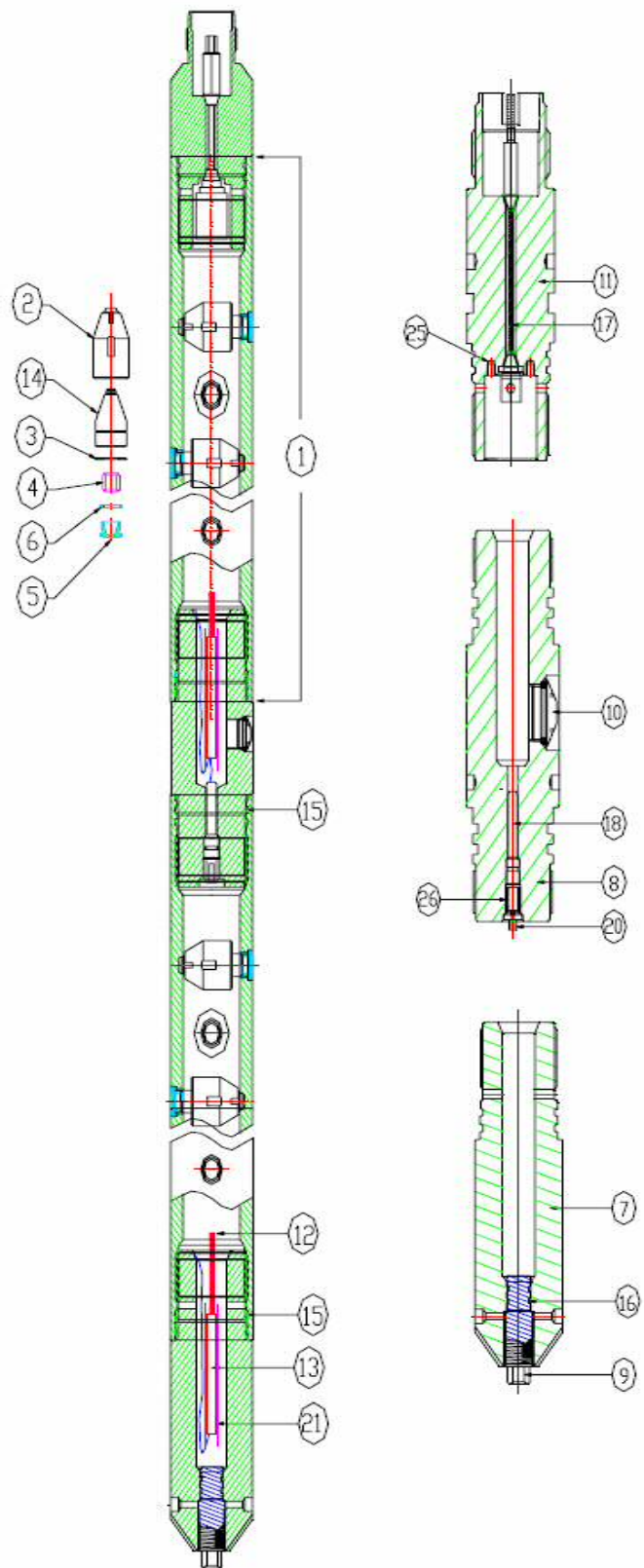

Section – B: Charges for Ported Carriers

DEEP PENETRATING and BIG HOLE CHARGES FOR PORTED GUNS GUN SIZES : 3-1/8", 3-3/8", 4" & 5"

ITEM	DESCRIPTION	EXPL WEIGHT	API SECT 1-TEST CONCRETE TARGET		PACKAGE QTY
			PEN	E.H.	
CHARGES					
1	3-1/8" DP 12 gm RDX / HMX PPG Charge	12 gm	16.07"	0.33"	50
2	3-3/8" DP 16 gm RDX / HMX PPG Charge	16 gm	19.05"	0.39"	50
3	4" DP 22.7 gm RDX / HMX PPG Charge	22.7 gm	23.43"	0.42"	50
4	4" BH 22.7 gm RDX / HMX PPG Charge	22.7 gm	23.43"	0.42"	50
5	5 " DP 37 gm RDX / HMX steel cased Charge 4 Shots per foot.SPF.	37 gm	47.30"	0.47"	30
6	5 " BH 37 gm RDX / HMX steel cased Charge 4 Shots per foot.SPF.	37 gm	8.50"	0.92"	30
7	5 " DP 21 gm RDX / HMX steel cased Charge 8 Shots per foot.SPF.	21 gm	22.56"	0.39"	50
8	5 " BH 21 gm RDX / HMX steel cased Charge 8 Shots per foot.SPF.	21 gm	7.78"	0.75"	50
HARDWARE					
9	Piston Switch, (Red Wire), 12,000 psi-330 Deg. F.				20
10	Piston Switch, (Green Wire), 12,000 psi-330 Deg. F.				20
11	Piston Switch, (Blue Wire), 15,000 psi-400 Deg. F.				10

RETRIEVABLE STEEL PORTED GUNS

Retrievable steel hollow carrier "port plug guns" are appropriate for wireline casing and liner perforating carried out before production tubing is run where the labor cost of redressing the carriers is economically viable.

FEATURES

- 1) Ported tabular steel carriers are retrievable and reusable.
- 2) Explosive components are completely enclosed and isolated from well fluids providing higher reliability than tubing expendable type guns
- 3) Deep penetrating charges and favourable shot distribution provide adequate gun performance.
- 4) Charge debris is removed from the well with the carrier.
- 5) No casing damage - lateral explosive forces are completely absorbed by the air cushion around the charges and heavy carrier walls.
- 6) Monocable selectivity - ballistically actuated switches or two-gun "diode plugs" firing carrier-by carrier, from bottom up.

SPECIFICATIONS

- | | | |
|--|---|--|
| 1) Shot Density | : | 1 to 8 shots per foot |
| 2) Phasing | : | 90 Deg. or 120 Deg. |
| 3) Maximum Gun Length: | : | Limited by cable strength and riser length. |
| 4) Explosive Package Temperature Rating | : | RDX - 330 Deg. F for 1 Hr
HMX - 380 Deg. F
for 1 Hr |
| 5) System Pressure Rating
(dependent on port plug accepted) | : | Carrier (usually 15,000 to 20,000 psi)
Port plug Type – 2,000psi 15,000psi 20,000psi. |